



FAIRLIE 77

A MODERN CLASSIC BY FAIRLIE YACHTS



PRESENTING THE NEW FAIRLIE 77
MODERN CLASSIC FROM FAIRLIE YACHTS.
BRINGING THE SPIRIT OF TRADITION
INTO THE FUTURE, FAIRLIE'S RENOWNED
EXPERTISE LIES IN DESIGNING AND
BUILDING CLASSIC YACHTS WHICH
EXUDE TIMELESS ELEGANCE.
DRAWING FROM OVER TWO DECADES OF
RESTORATION EXPERIENCE, THE TEAM
AT FAIRLIE ARE NOW APPLYING THEIR
SPECIALISED SKILLS AND KNOWLEDGE
TO BRING THEIR CLIENTS THE TRUE
QUALITY AND GENIUS OF A BYGONE ERA.

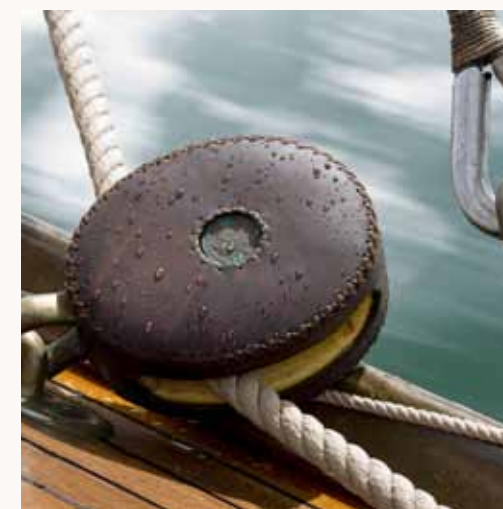



HERITAGE & TRADITION

For 20 years Fairlie Yachts have been defining the standard for classic yacht restoration, design and construction. Gaining inspiration from the incredible artistry of William Fife III, the firm have attained an in depth knowledge of the acclaimed designer's works and having restored many of his originals, currently hold Fife's design archive and continue

to building authentic replicas which are the envy of all true classical boat enthusiasts. Drawing from over two decades of restoration experience, and embracing some of the traditional boat building skills often lost to a modern generation, the team are now adept at bringing us a real taste of perfect styling to which the Fairlie 77 gives testimony.





OUR JOURNEY

Moving forward from the landmark restoration of the 1931 Fife schooner 'Altair' in which their principal staff were critically involved, Fairlie then rebuilt the large 1911 internationally famous racing yacht 'Mariquita'. The result was universally acclaimed as a masterpiece, from the stout backbone to the magical detail for which the yard is now famous. Fifteen major projects have followed, and Fairlie's core workforce of time-served shipwrights now lead a widely skilled crew who relish new challenges and innovative materials.

Fairlie's naval architect, Paul Spooner, is deeply committed to ensuring traditions are upheld when it comes to restorations.

'To be true to the original detail we manufacture everything exactly the way it was,' he says. 'We have a keen eye for maintaining heritage and tradition and a proven experience in the design and building of bespoke yachts.'

While originality is par for the course, Fairlie also employ 21st century products in order to slow down the degradation of traditional materials.

The team currently devote much time specialising in bespoke work, designing yachts to a client's specific requirements. Ensuring longevity and attention to detail is an absolute prerequisite of every project undertaken. Remaining true to the heart of classic tradition, the yachts are designed with long keels which provide the gentlest movement while carving a course through the water and alluring polished woodwork highlights ornate bronze fittings and billowing classic canvas sails all paint a picture of history and endurance.



“WHEN A CLIENT COMES TO FAIRLIE YACHTS THEY ARE LOOKING FOR THE EXQUISITE CRAFTSMANSHIP FOR WHICH WE HAVE BECOME RENOWNED AND WHICH EMBRACES AN AGE OLD MARITIME TRADITION. BLENDING THESE QUALITIES WITH STATE OF THE ART NAVAL ARCHITECTURE, I ENSURE THERE IS ABSOLUTELY NO COMPROMISE WHEN APPEALING TO THE REQUIREMENTS AND DESIRES OF THE MODERN YACHTSMAN. FUSING CONTEMPORARY ELEMENTS OF DESIGN WITH THE TRADITIONAL ASPECTS OF OUR CRAFT WE ENSURE OUR YACHTS ENJOY A TIMELESS ELEGANCE AND REMAIN PERFECTLY TRUE TO THEIR ROOTS.”

PAUL SPOONER, NAVAL ARCHITECT





MODERN CONSTRUCTION
AND CLASSIC ELEGANCE
ARE MARRIED TOGETHER
PERFECTLY AT THE WATERLINE.



FORWARD CABIN LAYOUT

The standard layout showing the '77 deck and cockpit configuration should you choose to have your Master Cabin Forward.



77

A BEAUTIFUL YACHT
COMPLETELY AT
EASE WITH HERSELF.
COMFORTABLE WHILE
CRUISING OR COMPETING.



AFT CABIN LAYOUT

Fairlie offer the alternative option which assures absolute privacy for their Yacht Owners, with the Master Cabin Aft, while guests benefit from the addition of a safe mid cockpit.





SAFE WITHIN THE INTIMATE
LUXURY OF YOUR FAIRLIE 77,
TIME HAS NO RELEVANCE.





EXTERIOR DETAIL





THE SALOON

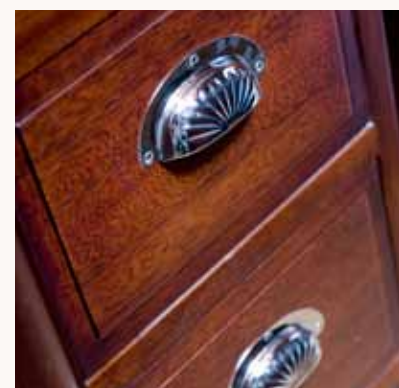

INTERIOR DETAIL

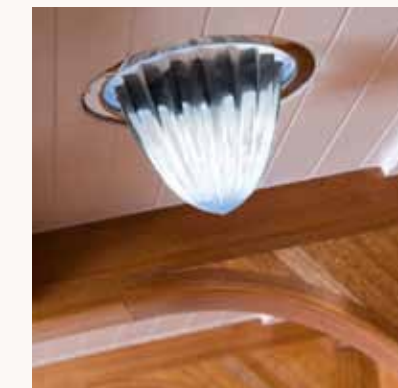



MASTER CABIN FORWARD

The Master Cabin Forward epitomises Fairlie's classic style with all the modern conveniences. Exuding elegance and simplicity, the large, spacious and light master cabin incorporates its own ensuite and offers the ultimate in comfort for its occupants.



FORWARD CABIN





MASTER CABIN AFT

While affording you the luxury of your private owner's entrance, this light and spacious Master Cabin Aft, comes complete with the advantages of its own ensuite, natural ventilation and those personal touches in the design.





CLASSIC FORWARD LAYOUT

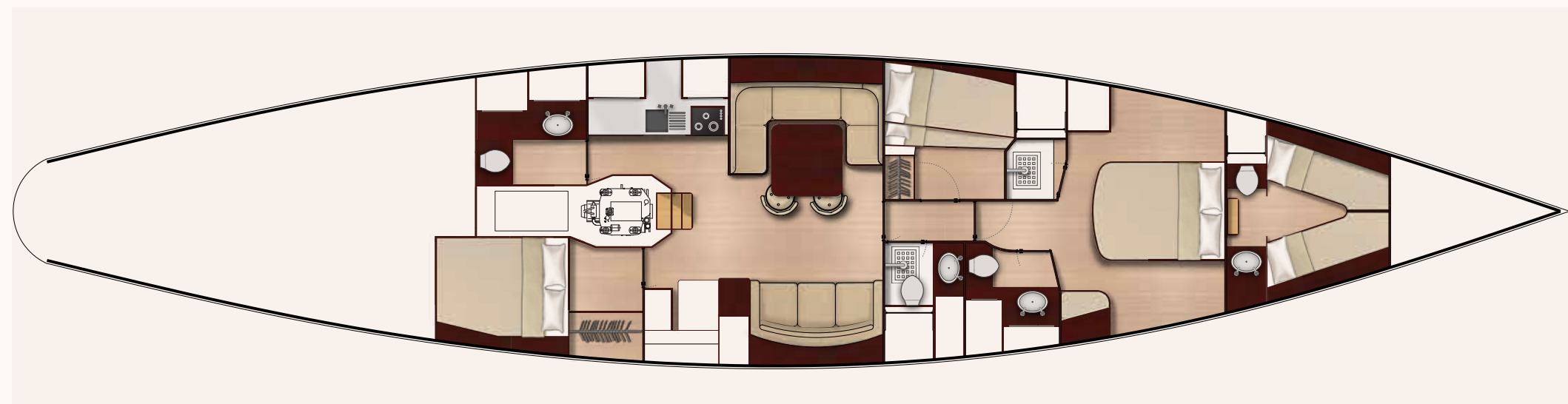

AFT CABIN LAYOUT





SPECIFICATION

LOA	23.50 m / 77' 8"
LWL	16.30 m / 53' 5"
Max Beam	5.00 m / 16' 4"
Draft	3.50 m / 11' 5"
Displacement	30 tonnes / 80,380 lbs
Sail Area	250 m ² / 2,691 sq.ft
Owner & Guest Berths	6 in 3 cabins
Crew Berths	2
Designer	Paul Spooner, Fairlie Yachts

ENGINE

Volvo D3-100 110 hp @3000rpm	
Water Capacity	750 litres / 165 gal
Fuel Capacity	1,000 litres / 227 gal
Speed under power	9 knots

CONSTRUCTION

HULL

The hull is constructed on a mahogany laminated backbone and frame structure. A layer of Douglas fir strip planking, two layers of mahogany veneers laid at 45 degrees and one layer fore & aft to give complete resistance to torsion, impact & longitudinal forces.

DECK

Teak swept decks are laid on a layer of marine plywood to create a beautiful flush deck from stem to stern. Varnished covering boards and traditional timber bulwarks finish the decks to perfection.

ACCOMMODATION

The Fairlie 77 offers two interior accommodation layouts.

As standard the large master cabin, with en-suite bathroom and separate wet room, is located forward of the saloon. For those owners who would prefer their 'master' cabin aft, Paul Spooner, has designed a very private cabin which has its own dedicated companionway access and private cockpit. This layout offers excellent privacy and separation from your guests and two crew. Whichever layout is preferred, the Fairlie 77 accommodates 4 cabins:

- 1 x Master cabin (fwd or aft)
- 1 x VIP Guest cabin (double or bunked cabin)
- 1 x Guest cabin (bunk cabin)
- 1 x Twin crew cabin in the forepeak forward

RIG OPTIONS



FAIRLIE 77

YAWL



FAIRLIE 77

SLOOP



ANOTHER MODERN CLASSIC BY

FAIRLIE YACHTS

EST 1985

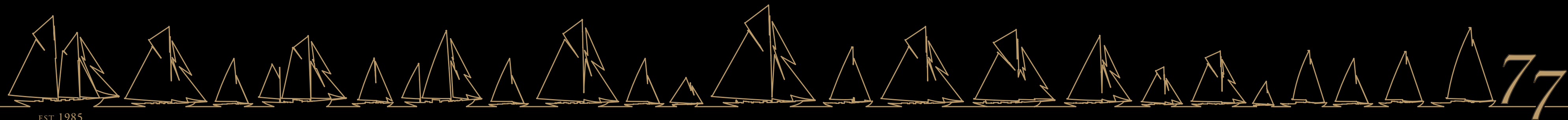

PORT HAMBLE,
HAMBLE,
SOUTHAMPTON,
UNITED KINGDOM,
SO31 4QD

E: enquiries@ancasta.com

T: +44 (0)2380 450000

WWW.FAIRLIEYACHTS.COM